



Flood Defender Doors

Installation Guide



At M3 we are continually searching the Globe for new technologies and working processes that we can harness to enable us to deliver Innovative solutions that benefit the Environment and provide enhanced value to our Clients

M3 Global Flood Technologies Ltd. 9a Wassage Way, Hampton Lovett Ind Est, Droitwich
Worcestershire WR9 0NX. **Tel: +44 (0)1905 676467 Email: sales@m3floodtec.com**

www.m3floodtec.com

Contents

Introduction **4**

Delivery Checklist **6**

Preparation **7**

Installation **8**

■ Introduction

Flood Defender Door

Specially designed flood doors suitable for use in both residential & smaller commercial properties.

The Flood Defender Door suitable for use on residential and smaller commercial properties to protect doorway apertures against water ingress. The Door holds a Kitemark to BS 851188-1:2019 and is manufactured for use on single, inward and outward opening doors, as well as double (UPVC) outward opening doors.



■ Delivery Checklist

- Check the door thoroughly for any damage or defects and photograph if any are present
- Check your survey to ensure all the measurements match your survey/purchase order
- Check to make sure the correct door design/glass options have been sent
- Check handle colour, letterbox, knocker, panel & glass option
- Check you have the correct keys



IMPORTANT – Any errors/defects must be notified in writing within 3days of delivery and BEFORE installation. Returns/complaints will not be accepted beyond this point.



IMPORTANT – Weights may vary depending on size of door/s ordered. Customers to make necessary risk assessments prior to lifting doors.

■ Preparation

1. Measure plaster for hinge clearance
2. Check implications for skirting or dado rails
3. Check clearance past floor level
4. Ensure the floor is prepared to hold new door
5. Ensure all brickwork around the aperture is pointed to create a solid base for the door sill to sit (A)



6. Ensure no cavity closers or strap fixings prevent installation (B)



■ Installation - Frame & Sill



1. Apply silicon to each side of the plaster reveal up to 1000mm high



2. Apply silicon to floor in preparation for fitting door sill



3. Apply compriband (tremco) to base of sill



4. Check surface of floor is level



5. Place sill on silicon base and firmly tap down into place



6. Check sill is level and silicon both sides of the sill (we will cover underside later in installation process)

■ Installation - Frame Extensions

7. When attaching frame extensions to increase the width of the frame and to ensure there is adequate hinge clearance for the door to function, follow these steps:

[If not then continue to page 10](#)



a. Silicon the length of the reveal side of the frame



b. Attach the frame extension and fix every 150mm on left and right side of extension



c. Seal every screw with silicon



d. Seal the frame extension at both ends



e. Apply compriband to the frame extension (see step 8 for more details on application of compriband)

■ Installation - Frame & Sill



8. Apply compriband on the bottom of the frame and both sides of the frame up to 1000mm

DO NOT run a continuous strip of compriband around corners it won't be able to expand correctly



9. Apply 2 rows of silicon across the top of the sill. Ensuring there are no voids



10. Slide door into place from the bottom



11. Push frame against silicon on plaster reveal. Position bottom first then ensure the frame is level



12. Install first fixing (hinge side) at 150mm high and seal with silicone

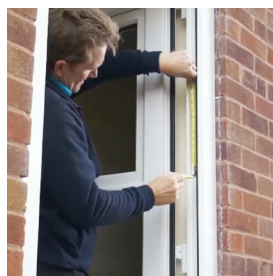

13. Once first fixing is in, install bottom fixing up to 300mm centres (hinge side)



14. Ensure you hit centre of brick with each fixing



15. Ensure all fixings below 600mm are sealed with silicone



16. Fix lock side at bottom (150mm high) and seal with silicone



17. Take any bow out of the frame and ensure it is plumb with no bowing or twisting. Close the door and ensure the gap is parallel



18. Fix with suitable fixings 300mm from centre

NB: Use adequate packing behind each fixing (this will help avoid bowing or twisting)



19. Check door operation using main door handle. To adjust, loosen the two screws in the keep (the lock can be adjusted later) reposition and tighten as necessary



Door frame may catch until 'toe & healed' in step

■ Installation - Panel & Glass



20. Apply sealant to rubber seals within sash

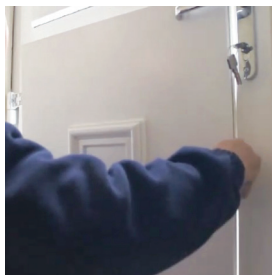

21. Fit panel /glass into position. Seal around the panels/glass both internally and externally



22. Ensure panel/glass are 'toe & healed' correctly. To lock adjustment – line up lines on locks to keep

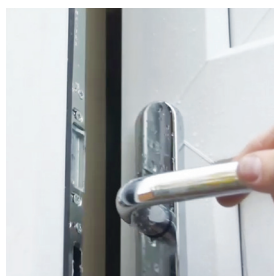

23. Ensure the lock can be operated /locked easily

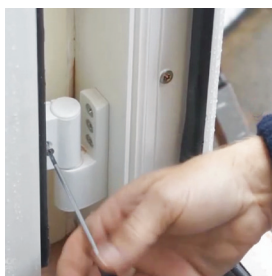

24. Fit the screws provided to stop the hinges moving and attach all hinge covers

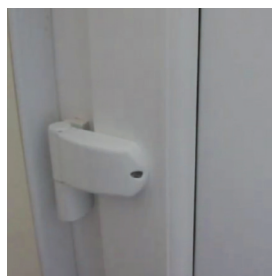

Ensure there is compression creating a watertight seal

Installation - Completion



25. Once door is operational, seal surrounding brickwork/ aperture – double check sill is sealed down the sides, underneath and up the side of the door to 1000mm using silicon



26. Trim inside/ outside neatly for a professional finish. Double check all panels/glass is sealed below 600mm



27. Add weep vents and seal with silicon



Don't block the front or back edge of door weep with silicone



28. Clean door/frame both internally and externally with approved UPVC cleaning solution to complete the install



29. Add lubricant to door seals



30. Handover to homeowner & explain the importance of the 12 month annual inspection requirement and terms of the warranty period

Any questions? Contact M3 Floodtec on +44 [0]1905 676467

■ Notes

This image shows a single sheet of white paper with horizontal blue or grey ruling lines. The lines are evenly spaced and run across the width of the page. There are approximately 20 lines visible. The paper has a slight shadow on its right side, suggesting it's resting on a surface.



M3 Global Flood Technologies Ltd.
9a Wassage Way, Hampton Lovett Ind Est
Droitwich, Worcestershire WR9 0NX

Tel: +44 (0)1905 676467

Email: sales@m3floodtec.com

m3floodtec.com